

NOTES:

- 1. FOR .062 [1.6MM] NOMINAL CIRCUIT BOARD THICKNESS

REV.	DATE	ECO	DESCRIPTION	BY	CK	APP
-	10/20/16	N/A	INITIAL RELEASE	KMH	N/A	N/A

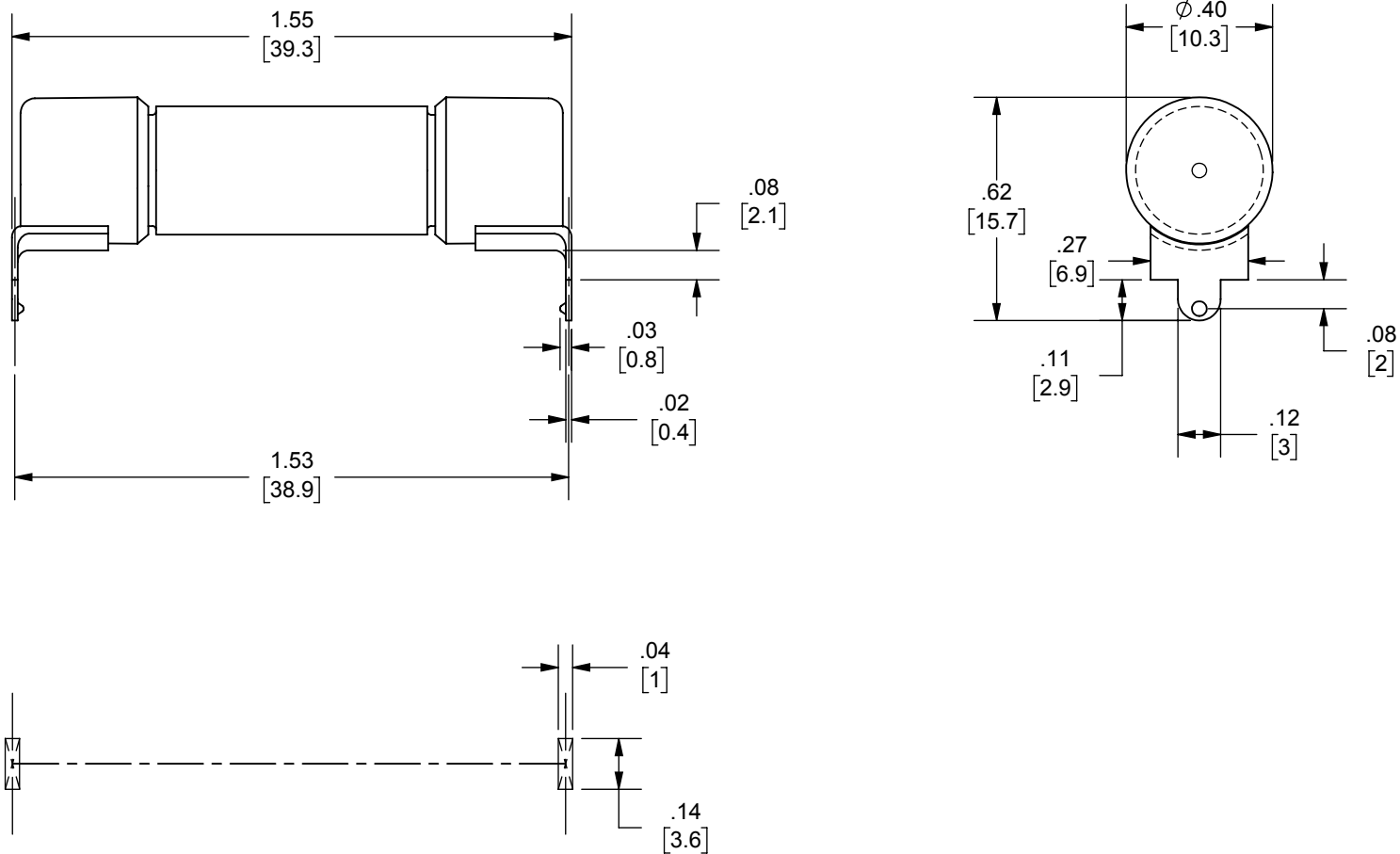

MOUNTING HOLE DETAIL

DIMENSIONS IN [] ARE MILLIMETERS



MERSEN USA NEWBURYPORT-MA, LLC
374 MERRIMAC STREET
NEWBURYPORT, MA 01950

MEV55C(5-30/50)-P

EV PACK FUSE

5-30/50A 550VDC

OUTLINE DIMENSIONS
NOT TO BE USED FOR PRODUCTION

702138

PRODUCT MANAGER

SIGN: B.KIRKORIAN

DATE: 11/22/16

DESIGN ENGINEER

SIGN: S.MOODY

DATE: 11/22/16