

REV.	DATE	ECO	DESCRIPTION	BY	CK	APP
-	12/17/2019	N/A	INITIAL RELEASE	RLM	N/A	N/A
B	1/29/2024	18032	UPDATED TITLE BLOCK, ADDED NOTES, DIM .44[11.2] WAS .50[12.7], 1 LBS FORCE WAS 2 LBS FORCE	YF	N/A	SEE ECO

NOTES:

- INDICATOR IS FLUSH WITH SURFACE A BEFORE FUSE OPENS  
INDICATOR EXTENDS .44 IN. [11.2mm] AFTER FUSE OPENS AND EXERTS AN 1 LBF AT THE END OF TRAVEL

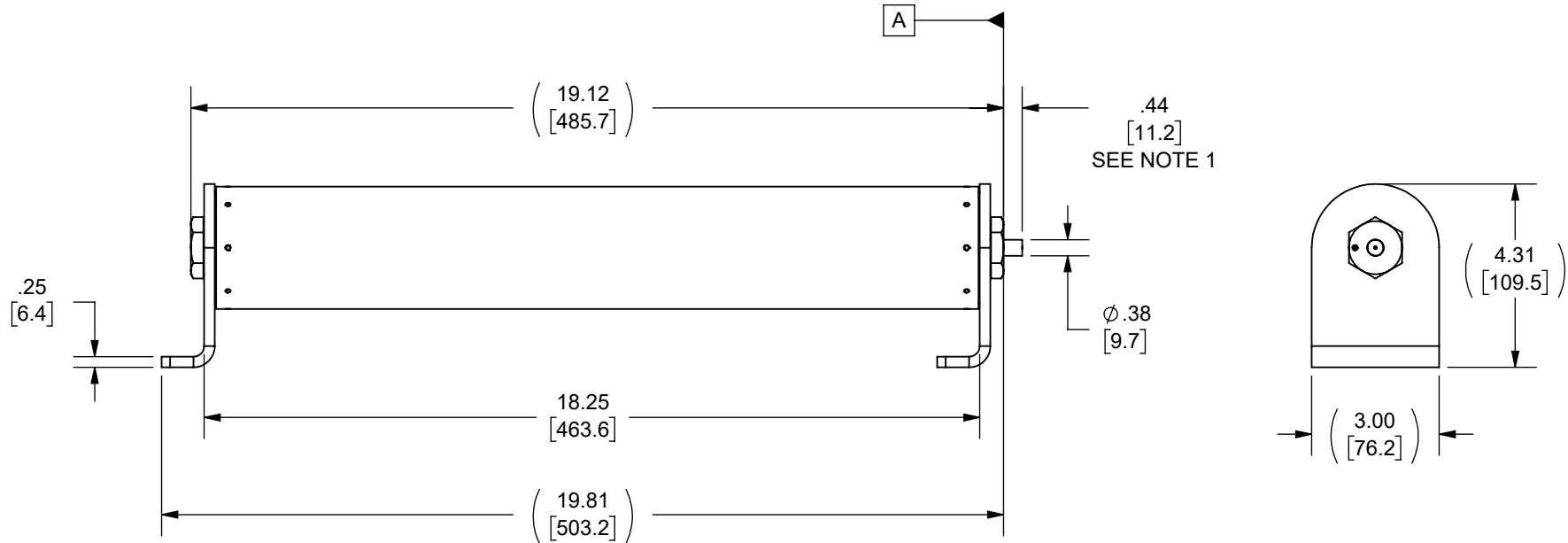

OUTLINE DIMENSIONS  
NOT TO BE USED FOR PRODUCTION

DIMENSIONS IN [ ]  
ARE MILLIMETERS

<i>Approval stage / Etat d'approbation:</i> <b>APPROUVÉ POUR FABRICATION / APPROVED FOR MANUFACTURING</b>		Product Class:/ Product Type: <b>MEDIUM VOLTAGE E-RATED</b>	
<i>Initial ECO / ECO intiale:</i> <b>ECO-18032-000</b>		Product amp rating:/ Voltage rating: <b>10-25E 15.5kV</b>	
<i>Draw by / Dessiné par:</i> <b>Yadyra Fang</b>		Title / Titre: <h1>OUTLINE</h1> <b>A155C1D0R0(10-25)E</b>	
Date : <b>6/14/2024</b>		Weight : Masse :	
<i>Checked by / Vérifié par:</i> <b>Luis ARMENTA</b>		Drawing / de dessin: <h1>702336</h1>	
Date : <b>6/14/2024</b>		Rev : <b>B</b> Rév :	
Electrical Power 374 MERRIMAC STREET NEWBURYPORT, MA 01950		Part / Article: <b>SEE TABLE</b>	
Éch / Scale : <b>1:4</b> Format / Size : <b>A</b>		Page : 1/1	

A155C1D0R0-25E
A155C1D0R0-20E
A155C1D0R0-15E
A155C1D0R0-10E
CATALOG NUMBER



Ce plan strictement confidentiel est la propriété exclusive de la société MERSEN sans l'autorisation écrite de laquelle il ne peut être ni reproduit, ni copié, ni communiqué à des tiers.  
 This drawing and specifications there on is property of MERSEN and shall not be reproduced or copied or used in whole or in part as the base for manufacture or sale of item without written permission.